

ST. TAMMANY PARISH COUNCIL

ORDINANCE

ORDINANCE CALENDAR NO. 2886

ORDINANCE COUNCIL SERIES NO. 04-

SPONSORED BY IMPASTATO

PROVIDED BY COUNCIL OFFICE

INTRODUCED BY MR. CANULETTE

SECONDED BY MR. IMPASTATO

ON THE 1ST DAY OF JULY 2004

ORDINANCE TO AMEND ORDINANCE COUNCIL SERIES NO. 04-0913, ADOPTED JUNE 3, 2004, TO EXPAND THE BOUNDARIES OF AN AREA SUBJECT TO A BUILDING MORATORIUM WITHIN WARD 7, DISTRICT 7

WHEREAS, to protect and preserve the health, safety and property interests of residents within Cypress Park Subdivision and surrounding areas, Ward 7, District 7 of St. Tammany Parish, a temporary moratorium on the issuance of permits for construction or placement of building structures within a portion of Cypress Park Subdivision was necessary to allow sufficient time for evaluation of adverse drainage conditions affecting the area; and

WHEREAS, upon initial review and evaluation of drainage conditions in the affected subdivision, it has been determined that adverse drainage conditions currently exist within a larger portion of the surrounding area, thus warranting an expansion of the boundaries of the moratorium currently in effect.

THE PARISH OF ST. TAMMANY HEREBY ORDAINS that it amends Ordinance Council Series No. 04-0913, adopted June 03, 2004, to expand the boundaries of the moratorium on the issuance of permits for the construction or placement of building structures within a portion of Cypress Park Subdivision in Ward 7, District 7, to include a larger area as more fully described herein and on the attached map:

An area, which boundaries commence at the intersection of U.S. Highway 190 and Anchorage Drive, also the point of beginning, thence follow Anchorage Drive in a northerly direction to its intersection with Berry Todd Road, thence follow Berry Todd Road in an easterly direction to its intersection with Graci Avenue, thence follow an imaginary line due south from said intersection to the northern most point of Emerald Drive, thence follow Emerald Drive south to its intersection with U.S. Highway 190, thence follow U.S. Highway 190 west northwest to its intersection with Anchorage Drive, also the point of beginning. All as indicated on the map attached hereto.

BE IT FURTHER ORDAINED that final adoption of this Moratorium shall operate to immediately prohibit the issuance of any building permit for property within the affected area regardless of any currently pending permit application.

BE IT FURTHER ORDAINED that the moratorium herein imposed may be vacated, in whole or in part, by Resolution of this governing body pursuant to Chapter 5, Article II, Section 5-056.00 of the Parish Code of Ordinances.

REPEAL: All Ordinances or parts of Ordinances in conflict herewith are hereby repealed.

SEVERABILITY: If any provision of this Ordinance shall be held to be invalid, such invalidity shall not affect other provisions herein which can be given effect without the invalid provision and to this end the provisions of this Ordinance are hereby declared to be severable.

DATE OF ENACTMENT: This Ordinance shall become effective immediately upon final adoption.

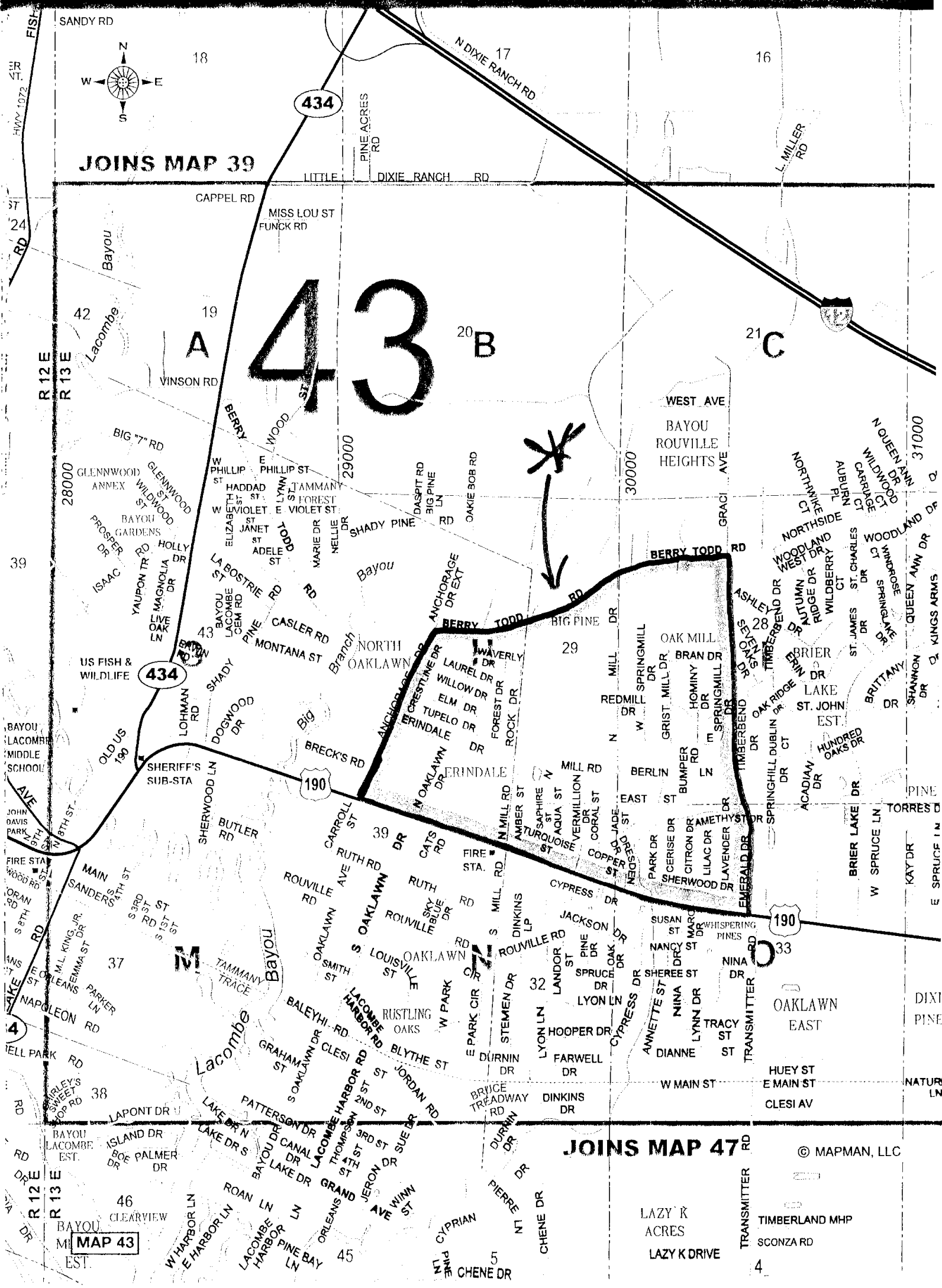

JOINS MAP 39

JOINS MAP 47

43

A

B

C

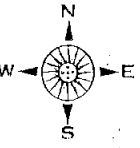

434

190

190

HWY 1072

R 12 E
R 13 E

R 12 E
R 13 E

SANDY RD

N DIXIE RANCH RD

PINE ACRES RD

LITTLE DIXIE RANCH RD

18

17

16

CAPPEL RD

MISS LOU ST
FUNCK RD

42

19

20

21

VINSON RD

WEST AVE

BAYOU ROUVILLE
HEIGHTS

BIG "7" RD

GLENWOOD ANNEX
WILDWOOD ST

W PHILLIP ST
HADDAD ST
VIOLET ST
JANET ST
ADELE ST
TODD ST
MONTANA ST

E PHILLIP ST
LYNN ST
TAMMANY FOREST
E VIOLET ST

DASPT RD
BIG PINE LN
OAKIE SOB RD

GRACI AVE

N QUEEN ANN
WILDWOOD CARRIAGE CT
AUBURN TRAIL
NORTHSIDE
WOODLAND CT
WILDBERRY CT
ST. JAMES ST. CHARLES
ST. JAMES DR
ST. JAMES DR
QUEEN ANN DR
KINGS ARMS

PROSPER DR
ISAAC DR
YAUPOIN TR RD
MAGNOLIA DR
LIVE OAK LN

LA BOSTRIE RD
BERRY TODD RD
CASLER RD
MONTANA ST

ANCHORAGE DR EXT
BERRY TODD RD
BIG PINE DR

MILL RD
W SPRINGMILL DR
GRIST MILL DR
HOMINY DR
SPRINGMILL DR

OAK MILL
BRAN DR
BERLIN

ASHLEY DR
TIMBERBEND DR
OAK RIDGE DR
BRIER DR
LAKE ST. JOHN EST.
HUNDRED OAKS DR
ACADIAN DR
W SPRUCE LN
KAY DR
E SPRUCE LN

39

434

29

BAYOU LACOMBE
MIDDLE SCHOOL

US FISH & WILDLIFE
LOHMAN RD
DOGWOOD DR

SHERIFF'S SUB-STA
SHERWOOD LN
BUTLER RD

BRECK'S RD
CARROLL ST
RUTH RD
OAKLAWN DR
RUTH DR
ROUVILLE DR

ERINDALE
ERINDALE DR
MILL RD
BERLIN

W SPRINGMILL DR
GRIST MILL DR
HOMINY DR
SPRINGMILL DR

BRITANNY DR
SHANNON DR
W SPRUCE LN
KAY DR
E SPRUCE LN

JOHN DAVIS PARK
5TH ST

OLD US RD
SHERWOOD LN

BUTLER RD
CARROLL ST
RUTH RD

ERINDALE
ERINDALE DR
MILL RD
BERLIN

W SPRINGMILL DR
GRIST MILL DR
HOMINY DR
SPRINGMILL DR

BRITANNY DR
SHANNON DR
W SPRUCE LN
KAY DR
E SPRUCE LN

ORAN RD
S 8TH ST

MAIN ST
SANDERS RD
S 4TH ST
S 5TH ST
S 6TH ST

ROUVILLE RD
OAKLAWN DR
RUTH RD
ROUVILLE DR

ERINDALE
ERINDALE DR
MILL RD
BERLIN

W SPRINGMILL DR
GRIST MILL DR
HOMINY DR
SPRINGMILL DR

BRITANNY DR
SHANNON DR
W SPRUCE LN
KAY DR
E SPRUCE LN

WELL PARK RD
SWEET'S RD

LAPONT DR
ISLAND DR
BOE PALMER DR

ROUVILLE RD
OAKLAWN DR
RUTH RD
ROUVILLE DR

ERINDALE
ERINDALE DR
MILL RD
BERLIN

W SPRINGMILL DR
GRIST MILL DR
HOMINY DR
SPRINGMILL DR

BRITANNY DR
SHANNON DR
W SPRUCE LN
KAY DR
E SPRUCE LN

WELL PARK RD
SWEET'S RD

LAPONT DR
ISLAND DR
BOE PALMER DR

ROUVILLE RD
OAKLAWN DR
RUTH RD
ROUVILLE DR

ERINDALE
ERINDALE DR
MILL RD
BERLIN

W SPRINGMILL DR
GRIST MILL DR
HOMINY DR
SPRINGMILL DR

BRITANNY DR
SHANNON DR
W SPRUCE LN
KAY DR
E SPRUCE LN

WELL PARK RD
SWEET'S RD

LAPONT DR
ISLAND DR
BOE PALMER DR

ROUVILLE RD
OAKLAWN DR
RUTH RD
ROUVILLE DR

ERINDALE
ERINDALE DR
MILL RD
BERLIN

W SPRINGMILL DR
GRIST MILL DR
HOMINY DR
SPRINGMILL DR

BRITANNY DR
SHANNON DR
W SPRUCE LN
KAY DR
E SPRUCE LN

WELL PARK RD
SWEET'S RD

LAPONT DR
ISLAND DR
BOE PALMER DR

ROUVILLE RD
OAKLAWN DR
RUTH RD
ROUVILLE DR

ERINDALE
ERINDALE DR
MILL RD
BERLIN

W SPRINGMILL DR
GRIST MILL DR
HOMINY DR
SPRINGMILL DR

BRITANNY DR
SHANNON DR
W SPRUCE LN
KAY DR
E SPRUCE LN

© MAPMAN, LLC

LAZY K ACRES
LAZY K DRIVE

TRANSMITTER
TIMBERLAND MHP
SCONZA RD

4

MAP 43